



ASSEMBLY INSTRUCTIONS

1 GALLON LIGHTED FISH BOWL

(SAVE THESE INSTRUCTIONS)

GETTING STARTED

See **IMPORTANT SAFETY INSTRUCTIONS & SETUP TIPS** section before operating this unit. Completely install aquarium before plugging in. For household use only.

- 1.) Remove all parts from package carefully
- 2.) The area you are going to place an aquarium should not get any direct sunlight and make sure to place the unit on a surface that cannot be damaged from water.
- 3.) Rinse the Tank with warm water only—**NEVER USE SOAP TO CLEAN THE TANK.**
- 4.) Add gravel and any decorations you are going to use.
- 5.) Fill Tank with water to within 1" of top.
- 6.) Install Light Socket Assembly by lining up notches in Light Hood. Push forward until flange of Light Socket Assembly is flush with Light Hood. Twist Clockwise until Light Socket Assembly is securely attached to the light hood. Take care to grasp the body of the Light Socket Assembly and not the switch when twisting.
- 7.) Place the Light Hood on top of the Tank and make sure it is seated fully onto the top of the Tank.
- 8.) Plug Light Socket Assembly into a standard 110 volt wall socket. Grasp body of socket when switching On and Off.
- 9.) **BEFORE ADDING FISH** the water should be checked for it's suitability to accept whatever type of fish you will be adding. **DO NOT OVERCROWD** we recommend only 1 fish in this aquarium.

Light Hood & Lens -
Lens must be in place
during operation.

#ASZES9 Light Socket
Assembly-see Getting
Started line 6 for assembly
instructions

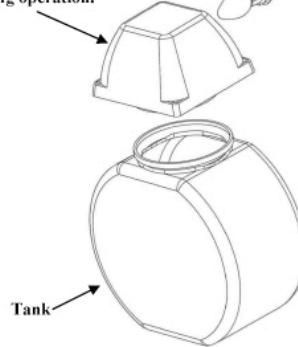

ISZCB2

TO REPLACE THE BULB

NEVER CHANGE THE BULB IF THE HOOD OR SOCKET ASSEMBLY IS WET

- 1.) Turn off light and let cool at least 5 minutes.
- 2.) Unplug Light Hood and remove from Tank
- 3.) Twist Socket Assembly counter clockwise and remove from Light Hood
- 4.) Unscrew the old bulb and screw in the replacement bulb making sure to **USE ONLY MAXIMUM 7 WATT (TYPE C-7) BULB.**
- 5.) Install Light Socket Assembly by lining up notches in Light Hood. Push forward until flange of Light Socket Assembly is flush with Light Hood. Twist Clockwise until Light Socket Assembly is securely attached to the light hood. Take care to grasp the body of the Light Socket Assembly and not the switch when twisting.
- 6.) Place the Light Hood on top of the Tank and make sure it is seated fully onto the top of the Tank.
THE CLEAR LENS MUST BE IN PLACE BEFORE OPERATING THIS UNIT!
- 7.) Plug Light Socket Assembly into a standard 110 volt wall socket.

Clear lens must be in
place during operation

Grasp body of
socket, not switch

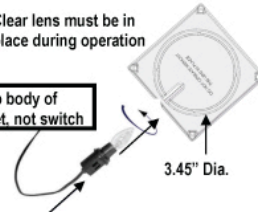

Turn Socket Assembly counter-
clockwise to remove.

**IF ANY PARTS ARE MISSING OR
DAMAGED, PLEASE CALL THE
NUMBER BELOW BEFORE RE-
TURNING AQUARIUM TO STORE.**

**FOR QUESTIONS OR COMMENTS
CALL:**

800-367-4821

OR VISIT US AT:

WWW.HAWKEYEAQUARIUM.COM

NOTE: The clear lens can be removed from the Light Hood for cleaning by pushing snaps back and lifting away from hood.

NOTE: Light Hood is designed to be used only with the tank