



ASSEMBLY INSTRUCTIONS FOR THE 1 GALLON AQUARIUM

(SAVE THESE INSTRUCTIONS)

GETTING STARTED

See IMPORTANT SAFETY INSTRUCTIONS & SETUP TIPS section before operating this unit. Completely install aquarium before plugging in. For household use only.

- 1). Remove all parts from package carefully.
- 2). The area you are going to place an Aquarium should not get any direct sun light and make sure to place the unit on a surface that cannot be damaged from water.
- 3). Rinse the tank with warm water only - **NEVER USE SOAP TO CLEAN THE TANK.**
- 4). Insert Riser Tube all the way into the socket provided in the Filter Plate.
- 5). Lower Filter Plate into Tank with the Riser Tube pointing up.
- 6). Add gravel and decorations as desired (purchased separately).
- 7). Connect Air Stone to end of Air Line Tubing and insert Air Stone into the Riser tube and place all the way to the bottom of the Riser Tube.
- 8). Connect the other end of the Air Line Tubing to the Air Pump.
- 9). Fill Tank with water to approximately 1/2" above the top of the Riser Tube.
- 10). Place the Light Hood onto the top of the Tank and make sure it is seated flush onto the Tank's rim. **THE CLEAR LENS MUST BE IN PLACE BEFORE OPERATING THIS UNIT!**
- 11). Install Light Socket Assembly by lining up notches in Light Hood. Push forward until flange of Light Socket Assembly is flush with Light Hood. Twist clockwise until Light Socket Assembly is securely attached to the Light Hood. Take care to grasp the body of the Light Socket Assembly and not the switch when twisting.
- 12). **NEVER SUBMERGE THE HOOD IN THE WATER** plug Light Hood into a standard 110 volt wall socket.
- 13). Form a drip loop as illustrated to the right and plug in the Air Pump into a standard 110 volt wall socket!
- 14). **BEFORE ADDING FISH** the water should be checked for it's suitability to accept whatever type of fish you will be adding. Please check the "Aquarium Setup Tips" insert for when to add fish and how many.

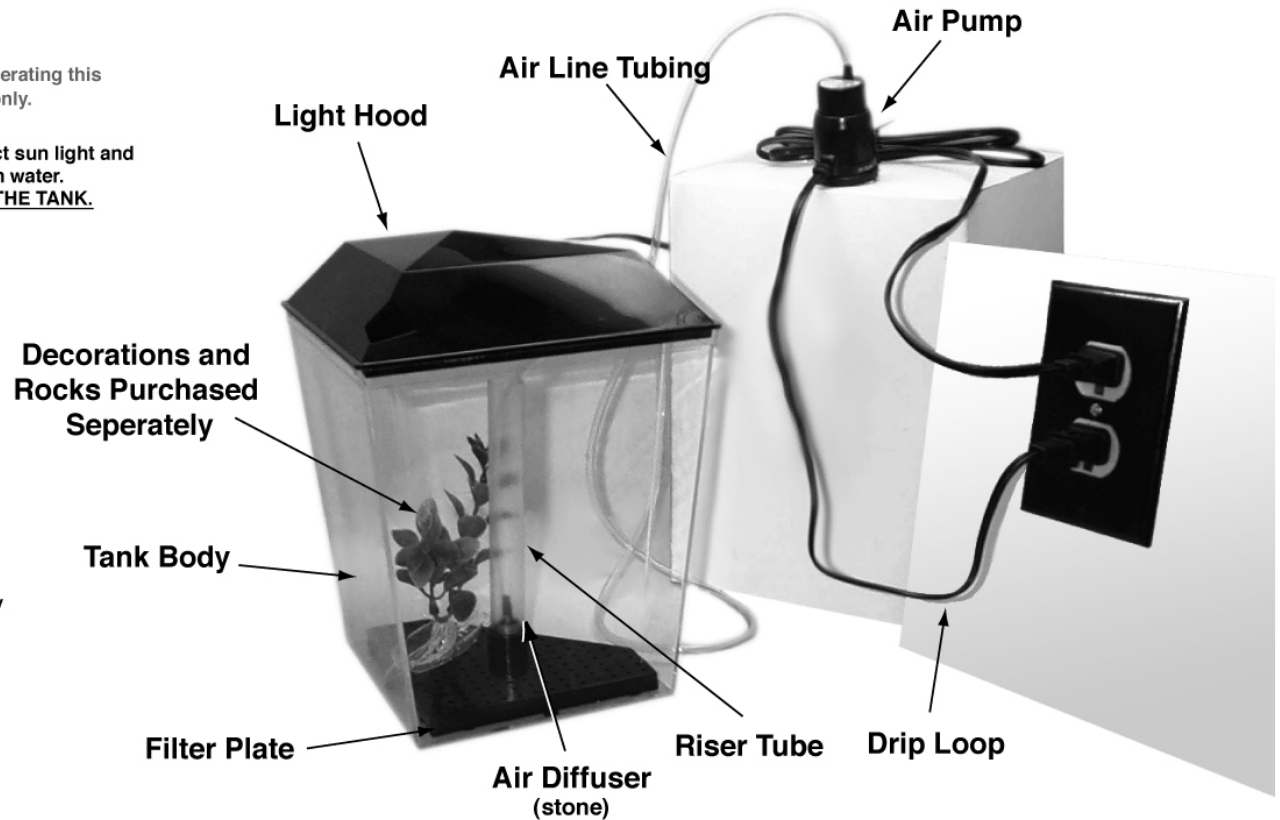

61291

TO REPLACE THE BULB

NEVER CHANGE THE BULB IF THE HOOD OR SOCKET ASSEMBLY IS WET

- 1). Turn off light and let cool, at least 5 minutes.
- 2). Unplug Light Hood and remove from Tank.
- 3). Twist Socket Assembly counter clockwise and remove from the Light Hood.
- 4). Unscrew the old bulb and screw in the replacement bulb making sure to **USE ONLY MAXIMUM 7 WATT (TYPE C-7) BULB.**
- 5). Install Light Socket Assembly by lining up notches in Light Hood. Push forward until flange of Light Socket Assembly is flush with Light Hood. Twist clockwise until Light Socket Assembly is securely attached to the Light Hood. Take care to grasp the body of the Light Socket Assembly and not the switch when twisting.
- 6). Place the Light Hood onto the top of the Tank and make sure it is seated flush onto the Tank's rim. **THE CLEAR LENS MUST BE IN PLACE BEFORE OPERATING THIS UNIT!**
- 7). Plug Light Hood back into a standard 110 volt standard wall socket.

Note: The clear lens can be removed from the Light Hood for cleaning using a small flat bladed tool or screw driver by carefully prying it out.

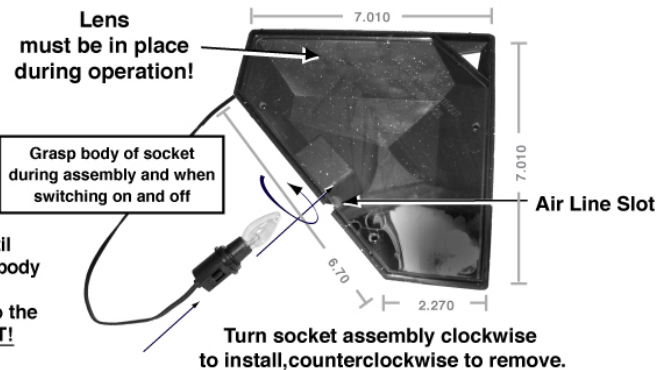

Note: Light hood is designed to be used with the tank provided with dimensions shown on hood above and a 5/16" recess.

IF ANY COMPONENTS ARE MISSING OR PARTS ARE DAMAGED, PLEASE CALL 800-367-4821 BEFORE RETURNING AQUARIUM TO STORE. NOT ALL PARTS ON THE REORDER FORM ARE INCLUDED, SOME ARE PURCHASABLE ACCESSORIES.

FOR QUESTIONS OR COMMENTS, CALL 1 (800) 367-4821 OR VISIT US AT WWW.HAWKEYEAQUARIUM.COM